

70 Shakespeare Road

Portsmouth, PO1 5LF

Asking price £220,000



Floor Plan

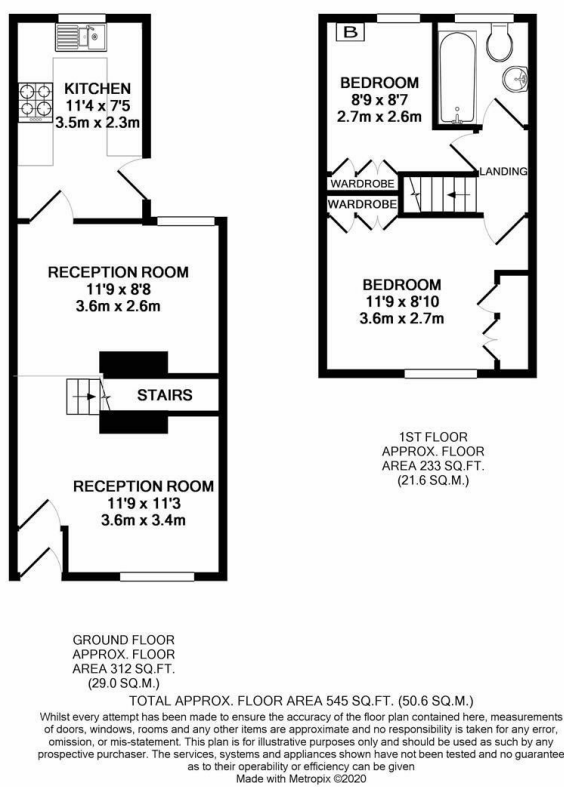

Area Map



Energy Efficiency Graph

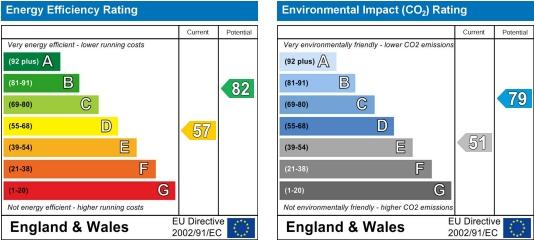

Offered for sale with no onward chain, this two bedroom home in Fratton would be ideally suited for first time buyers or those looking for a turnkey property with garden space.

The property has two reception rooms, offering flexibility whether you need separate living and dining areas or a work from home space.

The kitchen is a good size and located to the rear of the ground floor with direct access to the garden, which is well proportioned and nicely presented.

Upstairs, the property has two bedrooms, both of which have plenty of fitted storage, and the family bathroom.

The property further benefits from having had the boiler replaced at the end of 2023. It also has double glazing throughout.

Shakespeare Road is a one-way road situated in Fratton. The property is close to local schooling, shopping and transport routes through the city.

This lovely home is available for viewing by appointment.



These particulars, whilst believed to be accurate are set out as a general outline only for guidance and do not constitute any part of an offer or contract. Intending purchasers should not rely on them as statements of representation of fact, but must satisfy themselves by inspection or otherwise as to their accuracy. No person in this firms employment has the authority to make or give any representation or warranty in respect of the property.